

## AIR FILTER UNITS

## AFU 900



### WHO WE ARE?

- Arconik is an uprising multinational company
- An unique combination of expertise, R&D, know-how, and experience in the area of air filtration solutions positions Arconik as one of the most esteemed and fastest-growing companies in its field in the world.
- Our wide range of solutions provide protection for all, from the smallest system for family protection to systems for protections of thousands of civilians.
- The vast practical & real field experience we have gained through tens of thousands of our successful installations places us as one of the fast growing companies in its field in the world.

### MAIN FEATURES

- Filtering capacity 36-1800 m<sup>3</sup>/h is available.
- Filters are carefully and regularly tested and approved by various international laboratories.
- Pressure release valve for quick internal release of over/under pressure are provided to all range of filters.
- Maintenance-free, periodical monitoring is recommended.
- Hermetically delivered with a tamper-proof seal.

### ADVANTAGES

- Heavy duty steel housing with phosphate treatment and powder coating finished for high corrosion resistance.
- Includes shock absorbers for floor connection.
- Quick connectors are provided for fast and easy operation.
- Handles and castor wheels are provided for easy movement during installation. Includes shock absorbers once installed on the floor.



## APPLICATIONS

### Safe Rooms



### Hospitals



### Oil Refineries



### Power Plants



## TECHNICAL SPECIFICATIONS - AFU 900

Properties	Air Flow / Rated Capacity	Pressure Drop at Nominal Flow	Weight	Particulate Filtration Efficiency (AT 0.3 $\mu$ )	Working Temp. Range
Values	900	1000	195	$\geq 99.995$	-20 to +70
Units	m <sup>3</sup> /h	Pa	Kg	%	°C

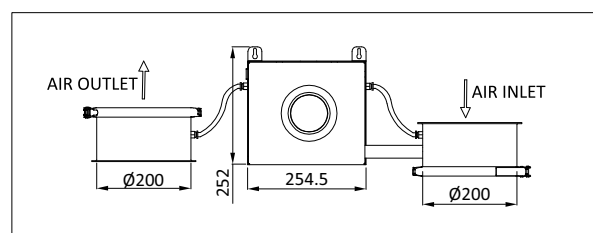
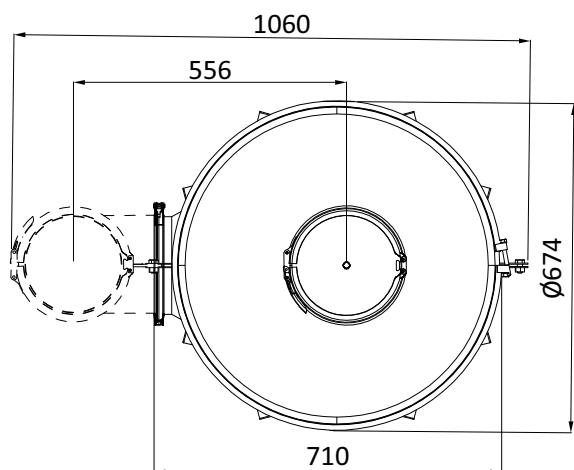

OPTIONAL DIFFERENTIAL PRESSURE GAUGE KIT  
(USEFUL FOR FLOW AND FILTER LIFE INDICATION)

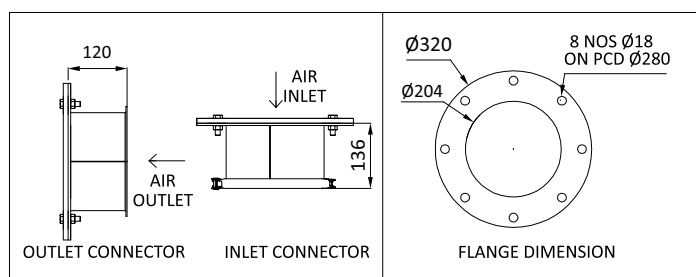

OPTIONAL KIT FOR REPLACEMENT OF QUICK CONNECTION TO FLANGE

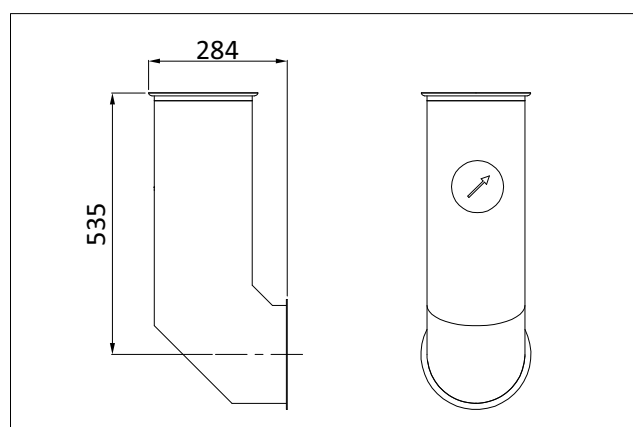
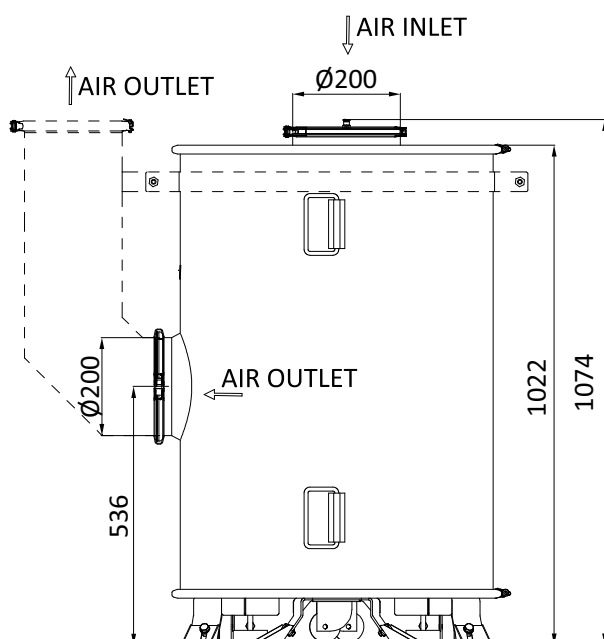

PIPE WITH FLOW INDICATOR FOR AFU 900